

Part Number: **TC1279-173KIT**  
Description: **ADAPTOR KIT, 100mm WBT YELLOW DUCT TO  
4" Panduit DUCT (STRAIGHT DUCT)**

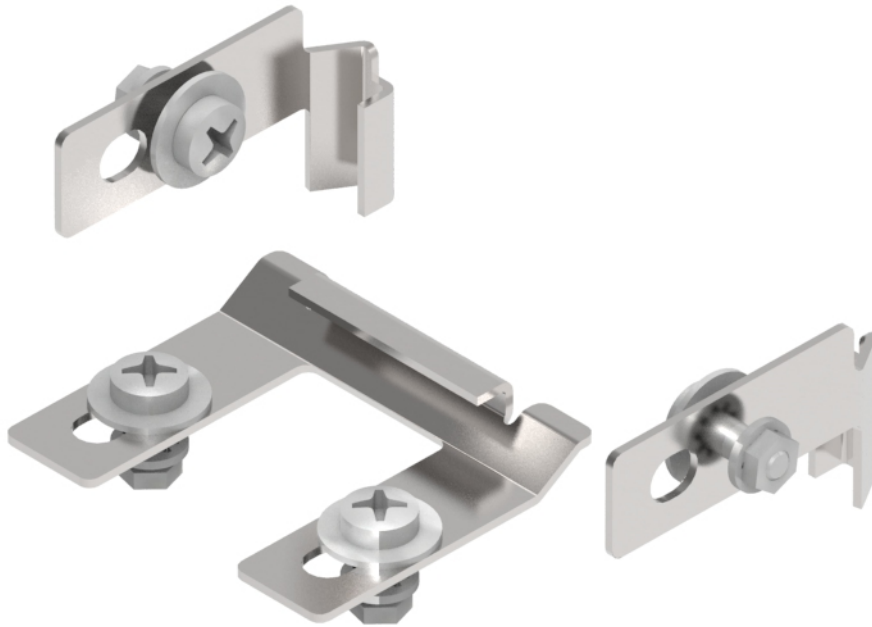

*Typical item shown*

## Use / Application:

The duct adapter kit is used to join existing 4" Panduit plastic duct to 100mm Yellow Duct. The kit consists of 1 base adaptor and 2 side adaptors with fasteners.

## Benefits & Features:

- Simple, clamp and bolt action, using only 4 nuts
- Fast, strong & reliable
- Smooth joint
- Includes: base adaptor, 2 side adaptors, 4 flat washers, 4 star washers & 4 nuts

## Technical Attriutes:

<b>Dimensions</b>	60mm (W) x 35 mm (H) x 70mm (D)
<b>Weight</b>	150g
<b>Materials</b>	Mild Steel, Nickel Plated