

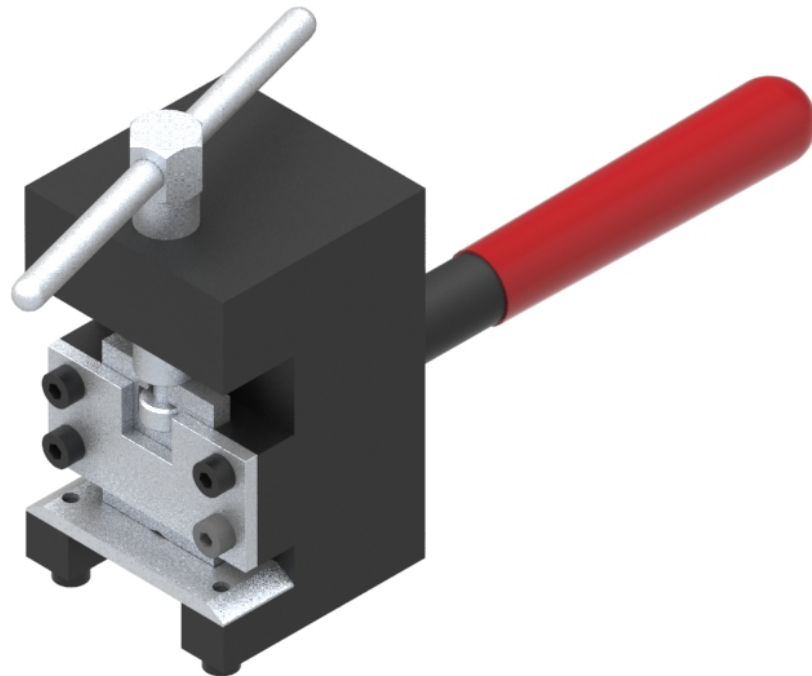

Part Number: **TC1279-118**  
Description: **SLOTING TOOL, for 50mm DUCT**



## Use / Application:

The slotting tool is used to make a small slot in the bottom and both sides at the end/s of 50mm duct. This process is a simple mechanical means of preparing a shortened length of 50 mm duct for connection to another standard part: e.g. elbow, cross connector, tees, 50mm - 30mm adapter assembly, duct end or drop-offs, etc. The duct joiner (Part No: TC1279-73) makes a strong and serviceable connection between these items.

## Benefits & Features:

- Simple, mechanical shear type slotting tool
- Joiner 50mm Duct (Part No: TC1279-73) not included
- Purchase as an individual item

## Technical Attributes:

<b>Dimensions</b>	110mm (W) x 115mm (H) x 160mm (D)
<b>Weight</b>	1.5kg
<b>Materials</b>	Mild steel