

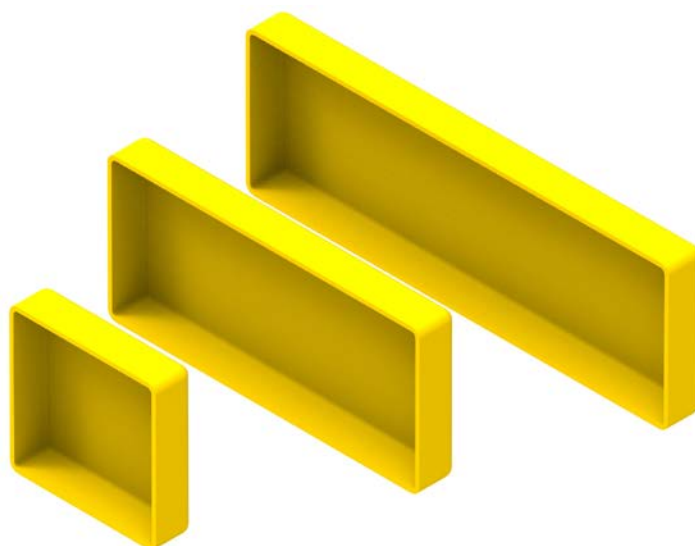

Part Number: **TC1279-251 / TC1279-252 / TC1279-288**
Description: **END COVERS, 100mm, 220mm, 300mm DUCT**



Use / Application:

These duct end covers are used for sealing the open end of a standard 100mm, 220mm or 300mm straight duct, respectively. They simply snap fit over the end of the duct, using the appropriate slotless duct joiner: 100mm duct joiner Part No: TC1279-248A; 220mm duct joiner: Part No: TC1279-250A; and 300mm duct joiner Part No: TC1279-287A. The duct joiners are available separately. These end covers can be removed with a screwdriver, should the duct system need extending.

Benefits & Features:

- Clips straight into either: 100mm, 220mm or 300mm duct end, using appropriate slotless duct joiner: (100mm duct joiner Part No: TC1279-248A; 220mm duct joiner: Part No: TC1279-250A; and 300mm duct joiner Part No: TC1279-287A)
- Slotless duct joiners are available separately
- Tough, fire retardant material
- Purchase by the unit

Technical Attributes:

Part No		Weight (Grams)	Dimensions (W)mm x (H)mm x (D)mm
TC1279-251	(100mm Duct)	62	116mm (W) x 114mm (H) x 28mm (D)
TC1279-252	(220mm Duct)	220	226mm (W) x 114mm (H) x 28mm (D)
TC1279-288	(300mm Duct)	300	305mm (W) x 114mm (H) x 28mm (D)

Material: Fire retardant plastic, Halogen free, UL94-VO rated