

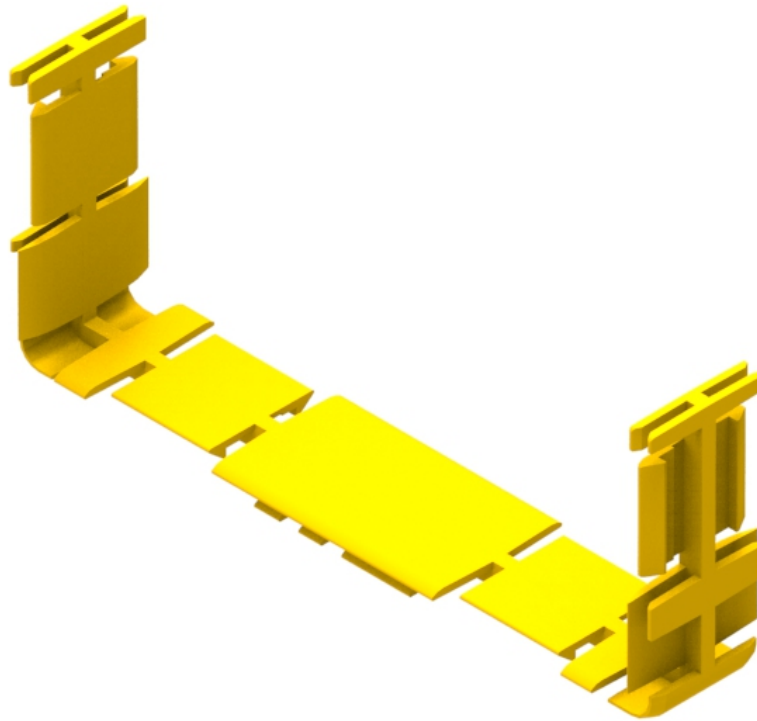

Part Number: TC1279-25  
Description: JOINER – 220mm DUCT



## Use/Application:

The joiner is used to connect standard 220mm straight ducting with itself or any of the other 220mm components; with which it provides a smooth & strong joint. Typical other fittings: are horizontal or vertical elbows, cross connectors, tees, etc.; which require a standard joiner at each interface.

**Note:** A 220mm slotless joiner is also available. It is (Part No: TC1279-250A).

## Benefits & Features:

- Tough, fire retardant material
- Clips straight into standard 220mm parts
- Purchase by the unit

## Technical Attributes:

<b>Dimensions</b>	43mm (W) x 94mm (H) x 232mm (D)
<b>Weight</b>	70g
<b>Materials</b>	Fire retardant plastic, Halogen free, UL94-VO rated