

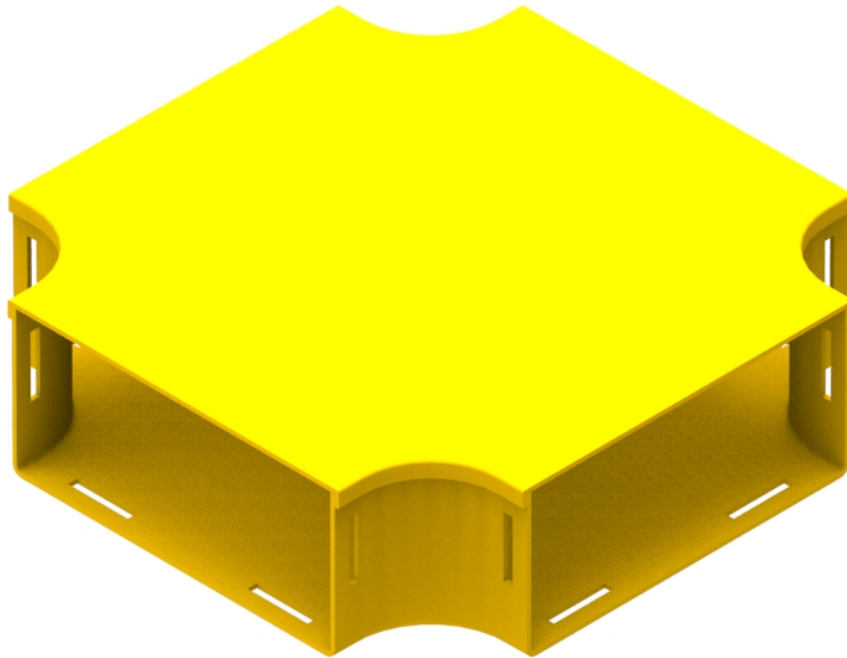

Part Number: **TC1279-61A**
Description: **CROSS CONNECTOR ASSEMBLY,
220mm DUCT**



Use/Application:

This connector is used to establish a right-angled intersection between two 220mm ducts. I.e. all 4 arms of the connector are connected to 220mm duct or other components via a: standard joiner (Part No: TC1279-25, Telstra No: 035300515) or a slotless joiner (Part No: TC1279-250A).

Note: Care should be taken not to lay more than 50mm depth of pigtails or patch cords in troughing, particularly where they cross each other at right angles. This may occur with this connector.

Benefits & Features:

- Includes cover (Part No: TC 1279-62)
- Clips straight into joiner
- Tough, fire retardant material
- Joiners (Part No's: TC1279-25, Telstra No: 035300515 or TC1279-250A); available separately
- Purchase by the unit

Technical Attributes:

Dimensions	360mm (W) x 105mm (H) x 360mm (D)
Weight	1.35kg (Lid = 410g)
Materials	Fire retardant plastic, Halogen free, UL94-V0 rated