

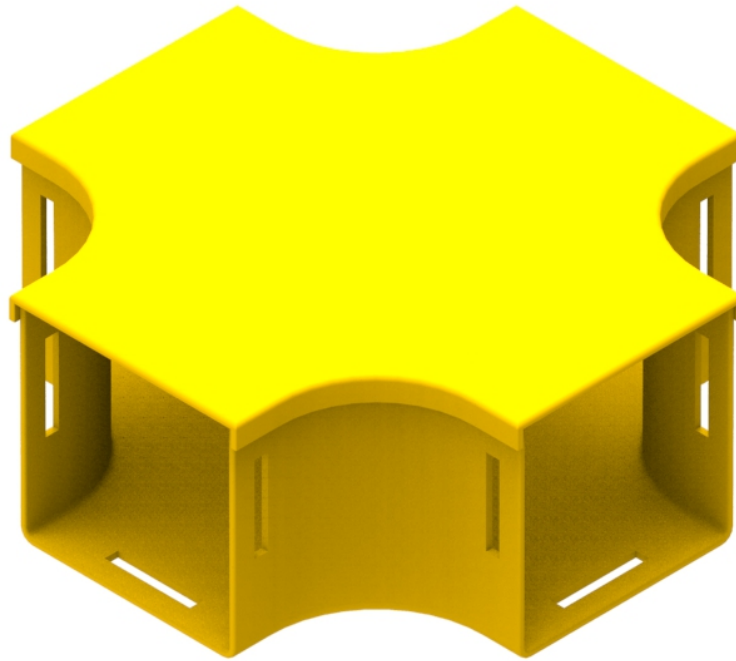

Part Number: **TC1279-71A**  
Description: **CROSS CONNECTOR ASSEMBLY,  
100mm DUCT**



## Use/Application:

This connector is used to establish a right angled intersection between two 100mm ducts. I.e. all 4 arms of the connector are connected to 100mm duct or other components using either: a standard joiner (Part No: TC1279-27, Telstra No: 035300514) or a slotless joiner (Part No: TC1279-248A).

**Note:** Care should be taken not to lay more than 50mm depth of pigtails or patch cords in troughing, particularly where they cross each other at right angles. This may occur with this connector.

## Benefits & Features:

- Includes cover (Part No: TC 1279-70)
- Clips straight into joiner
- Tough, fire retardant material
- Joiners (Part No's: TC1279-27, Telstra No: 035300514 or TC1279-248A); available separately
- Purchase by the unit

## Technical Attributes:

<b>Dimensions</b>	246mm (W) x 105mm (H) x 246mm (D)
<b>Weight</b>	520g
<b>Materials</b>	Fire retardant plastic, Halogen free, UL94-VO rated